



Overview

A versatile welder's tool designed to withstand the toughest environments. Unique lightweight construction reduces operator fatigue. Operates with unsurpassed power for peening or scaling operations.

CAUTION:

1. Never operate these hammers without a chisel in them or when the chisel is not securely against the work.
To do so will damage drive piston.
2. Barrel must be kept tight at all times. Loose barrel will cause stripping of threads in handle and power loss.
3. Use hose whip directly into inlet bushing to eliminate operator fatigue and to facilitate tool maneuverability.

Features/Benefits

- Powerful peening action (0 to 13,000 blows per minute) promotes dense, sound weld deposits
- Peening action stress relieves weld deposit
- Lightweight, 20 oz. (567g), and compact for operation in tight places
- Easily converts to a needle scaler

Applications

- Round nose peening tool is excellent for use when welding porous cast iron – actually closes pores while stress relieving the weld deposit
- Flat chisel rapidly removes weld spatter and scale
- Peening attachment quickly removes even the toughest weld slag covering

Directions for Use

Force and speed of hammer blows can be regulated by the depression of the trigger. Light pressure on the trigger starts the hammer blows at a slow rate. Full power is reached when trigger is fully depressed. Maximum efficiency is reached when tool is operated on 90 PSI at 8 cfm. Before starting a new tool, pour a small amount of lightweight pneumatic oil (no heavier than SAE 10) into the air inlet, connect hose and run tool momentarily to distribute the oil into all working parts. Insert several more drops in the air inlet after every two or three hours of operation. If unit is in constant use, it must be equipped with an air line lubricator and filter. Never operate without attachment in tool, or when attachment tool is not securely against work.

Technical Specifications

Blows per Minute: 0 to 13,000
 Air Consumption at 90 PSI: 3 to 8 cfm
 Weight: 20 oz. (567g)
 Tool Shank Diameter: 7/16"
 Overall Length: 6" (15.3cm) without attachment

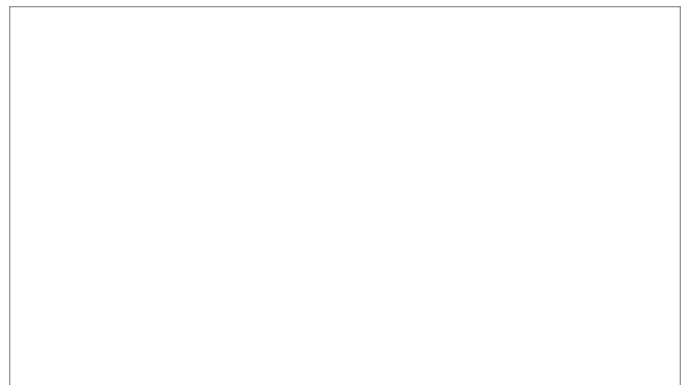

Pneumatic Peening Tool (CW1670)/Needle Scaler (CW1672) Parts List

When ordering, Part No., Serial No. and Unit Model must be specified.

Part No. Description

SO34	Pistol Grip Handle
SO35	Piston
SO36	Trigger Assembly
SO37	Retainer Ring
SO38	Large Rubber Seal
SO39	Small Rubber Seal
SO40	1/4" Steel Ball
SO41	Locking Washer
SO42	Barrel
SO43	Spring
SO44	Washer
SO45	Collar

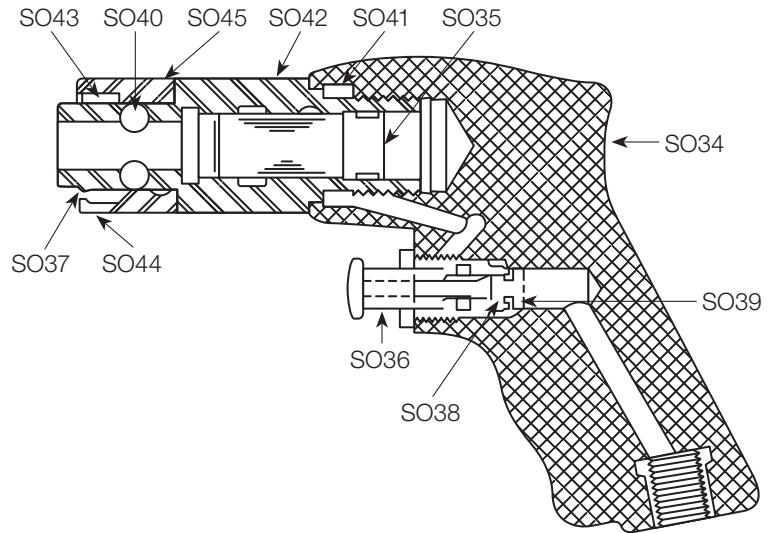

Needle Scaler (CW1672) Attachment Procedure:

1. Remove retainer ring (SO37) located at the front of the chuck collar.
2. Slide collar (SO45) forward.
3. Remove spring (SO43) and two 1/4" steel balls (SO40).
4. Slide needle scaler attachment over barrel, aligning screws with the ball holes, and tighten securely.

Disassembly of Complete Tool:

1. Place chisel in chuck of tool and secure chisel in vise.
2. Remove handle from tool by turning counterclockwise with wrench.
CAUTION: Upon re-assembly, be sure new locking washer (SO41) is replaced.
3. Remove piston from barrel.
4. Remove tool retainer collar (SO45) by taking off retainer ring (SO37).
5. Remove trigger assembly (SO36) by unscrewing counterclockwise.

Accessories:



Needle Scaler Adapter Kit – Carbon Steel
Part No. CW1672



Needle Replacement Kit
Part No. CW1671 – Carbon Steel
Part No. CW1669 – Stainless Steel



3-1/2" Round Nose Peening Tool
Part No. CW1673



4" Flat Chisel
Part No. CW1675



7" Round Nose Peening Tool
Part No. CW1674